

AEG



user guide
AEG Ligth

1	<u>IMPORTANT SAFETY INSTRUCTIONS</u>	4
2	<u>INSTALL YOUR PHONE</u>	5
2.1	CONNECT THE BASE STATION	5
2.2	INSTALL AND CHARGE THE BATTERIES	5
3	<u>GET TO KNOW YOUR PHONE</u>	6
3.1	HANDSET OVERVIEW	6
3.2	BASE OVERVIEW	8
3.3	HANDSET LCD DISPLAY	9
3.4	MENU STRUCTURE	10
4	<u>USE YOUR PHONE</u>	11
4.1	MAKE AN EXTERNAL CALL	11
4.1.1	PREPARATORY DIALING	11
4.1.2	DIRECT DIALING	11
4.1.3	CALL FROM THE PHONEBOOK	11
4.1.4	CALL FROM THE CALL LIST	11
4.1.5	CALL FROM THE REDIAL LIST	11
4.1.6	CALL TIMER	11
4.2	ANSWER A CALL	11
4.3	END A CALL	11
4.4	ADJUST EARPIECE AND HANDSFREE VOLUME	11
4.5	MUTE A CALL	11
4.6	SET THE SILENT MODE	12
4.7	REDIAL	12
4.7.1	REDIAL A NUMBER FROM THE REDIAL LIST	12
4.7.2	SAVE A REDIAL NUMBER INTO THE PHONEBOOK	12
4.7.3	DELETE A REDIAL NUMBER	12
4.7.4	DELETE THE ENTIRE REDIAL LIST	12
4.8	KEYPAD LOCK	12
4.9	FIND HANDSET	12
4.10	ACCESS INBOX	12
4.11	MAKE AN INTERNAL CALL	12
4.11.1	INTERCOM ANOTHER HANDSET	12
4.11.2	TRANSFER AN EXTERNAL CALL TO ANOTHER HANDSET	13
4.11.3	MAKE A 3-WAY CONFERENCE CALL	13
5	<u>PHONEBOOK</u>	14
5.1	ADD A NEW ENTRY	14
5.2	EDIT AN ENTRY	14
5.3	VIEW AN ENTRY	14
5.4	COPY AN ENTRY	14
5.5	COPY ALL ENTRIES	14
5.6	DELETE AN ENTRY	15
5.7	DELETE THE ENTIRE PHONEBOOK	15
5.8	VIEW PHONEBOOK CAPACITY	15
5.9	EDIT CALL GROUP	15
5.9.1	EDIT CALL GROUP NAME	15
5.9.2	CHANGE CALL GROUP RINGTONE	15
5.10	SPEED DIAL	16

5.10.1	EDIT A SPEED DIAL.....	16
5.10.2	DELETE A SPEED DIAL.....	16
6	<u>CALL LIST.....</u>	17
6.1	VIEW THE CALL LIST.....	17
6.2	STORE A CALL LIST NUMBER INTO THE PHONEBOOK.....	17
6.3	DIAL A CALL LIST NUMBER.....	17
6.4	DELETE AN ENTRY IN THE CALL LIST.....	17
6.5	DELETE THE ENTIRE CALL LIST	17
6.6	STORE ALL CALLS OR ONLY UNANSWERED CALLS IN THE CALL LIST.....	17
6.7	TURN ON OR OFF THE NEW CALL ALERT.....	17
7	<u>SOUND.....</u>	18
7.1	HANDSET RINGER.....	18
7.2	TONES	18
8	<u>SETTINGS.....</u>	19
8.1	HANDSET SETTINGS	19
8.1.1	ENABLE THE DIRECT CALL.....	19
8.1.2	DISABLE THE DIRECT CALL.....	19
8.1.3	SET AN ALARM	19
8.1.4	SET AN ALARM	19
8.1.5	SELECT BASE STATION.....	19
8.1.6	ADJUST THE DISPLAY CONTRAST, RENAME HANDSET, SELECT WALLPAPER AND COLOUR THEME.....	19
8.1.7	SET LANGUAGE (OPTIONAL).....	20
8.1.8	TURN ON OR OFF THE AUTO ANSWER	20
8.1.9	REGISTER AN ADDITIONAL HANDSET	20
8.1.10	DE-REGISTER A HANDSET.....	20
8.1.11	RESTORE THE HANDSET TO DEFAULT SETTINGS	20
8.2	BASE SETTINGS.....	20
8.2.1	SET THE BASE RINGER.....	20
8.2.2	SET THE HANDSET PRIORITY	20
8.2.3	SET THE DIAL MODE.....	21
8.2.4	SET THE FLASH TIME.....	21
8.2.5	SET DATE AND TIME.....	21
8.2.6	CHANGE THE SYSTEM PIN.....	21
8.2.7	SET AN EXCHANGE CODE	21
8.2.8	ACTIVATE THE ECO MODE (OPTIONAL)	22
8.2.9	RESET THE BASE SETTINGS TO DEFAULT SETTINGS	22
9	<u>DEFAULT SETTINGS.....</u>	22
10	<u>TROUBLESHOOTING.....</u>	23
	<u>CONFORMITY.....</u>	23

1 IMPORTANT SAFETY INSTRUCTIONS

When using your telephone equipment, basic safety precautions should always be followed to reduce the risk of fire, electric shock and injury, including the following:

- 1) Read and understand all the instructions.
- 2) Follow all warnings and instructions marked on the product.
- 3) Unplug this product from the wall outlet before cleaning. Do not use liquid cleaners or aerosol cleaners. Use a damp cloth for cleaning.
- 4) Do not use this product near water (for example, near a bath tub, kitchen sink, swimming pool).
- 5) Do not overload wall outlets and extension cords as this can result in the risk of fire or electric shock.
- 6) Unplug this product from the wall outlet and refer servicing to Vtech under the following conditions:
 - When the power supply cord or plug is damaged or frayed.
 - If the product does not operate normally by following the operating instructions.
 - If the product has been dropped and the cabinet has been damaged.
 - If the product exhibits a distinct change in performance.
- 7) Avoid using a telephone (other than a cordless type) during an electrical storm. There may be a remote risk of electric shock from lightning.
- 8) Do not use the telephone to report a gas leak in the vicinity of the leak.
- 9) Use only the supplied NiMH (Nickel Metal Hydride) batteries! The operation periods for the handsets are only applicable with the default battery capacities
- 10) The use of other battery types or non-rechargeable batteries/primary cells can be dangerous. These may cause interference and/or unit damages. The manufacturer will not be held liable for damage arising from such non-compliance.
- 11) Do not use third party charging bays. The batteries may be damaged.
- 12) Please note the correct polarity while inserting the batteries.
- 13) Do not immerse batteries in water, do not place in fire.

Package contents



The package contains the following items:

- 1 Handset
- 1 Base station
- 1 AC power adapter
- 1 Telephone line cord
- 1 Battery pack
- 1 User manual

The maximum range between the base station and the handset is approximately 300 meters. Depending on the surrounding conditions as well as spatial and structural factors, the range may be reduced. The range indoors is normally less than outdoors.

2 INSTALL YOUR PHONE

2.1 Connect the Base Station

- 1) Plug the power supply  & line cord  into the base station.
- 2) Plug the power supply & line cord into the wall socket.
- 3) The base indicator lights up. The answering machine is switched on.
- 4) Always use the cables provided in the box.

2.2 Install and Charge the Batteries

- 1) Slide out the battery compartment cover.
- 2) Place the supplied battery pack as indicated. Locate the battery lead and connector and plug it into the socket inside the battery compartment (the red wire should be on the left). Tuck the battery leads in the space above the battery.
- 3) Slide the battery compartment cover back.
- 4) Put the handset on the base and charge the battery for 14 hours first time. A beep indicates that the handset is properly placed on the base or charger.

Use only the NiMH battery pack provided.

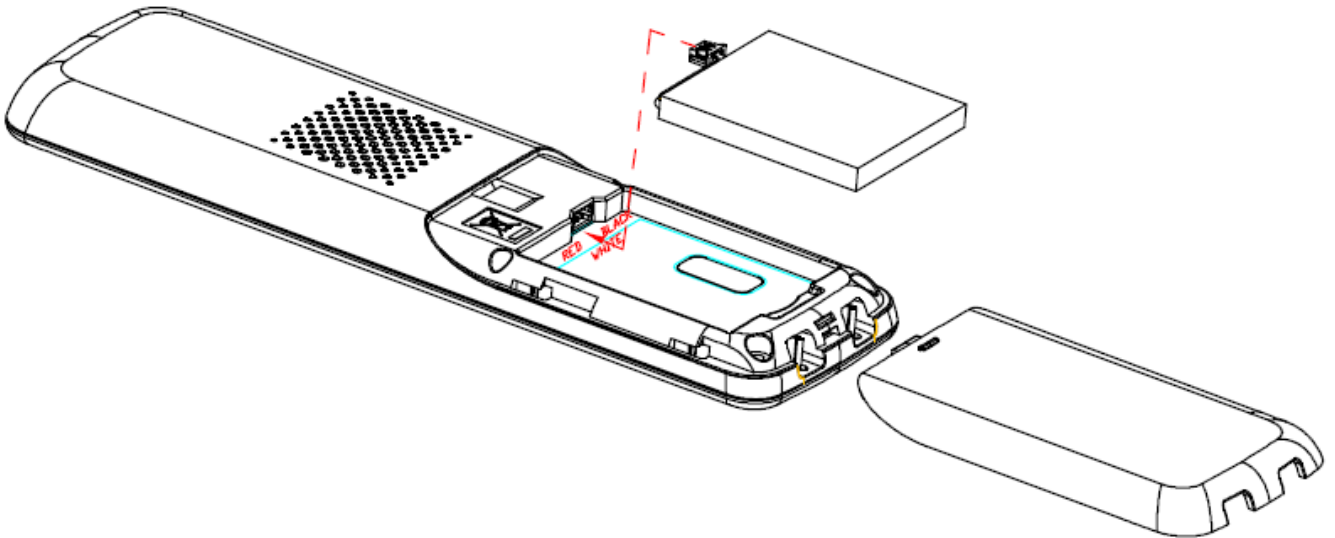

3 GET TO KNOW YOUR PHONE
3.1 Handset Overview

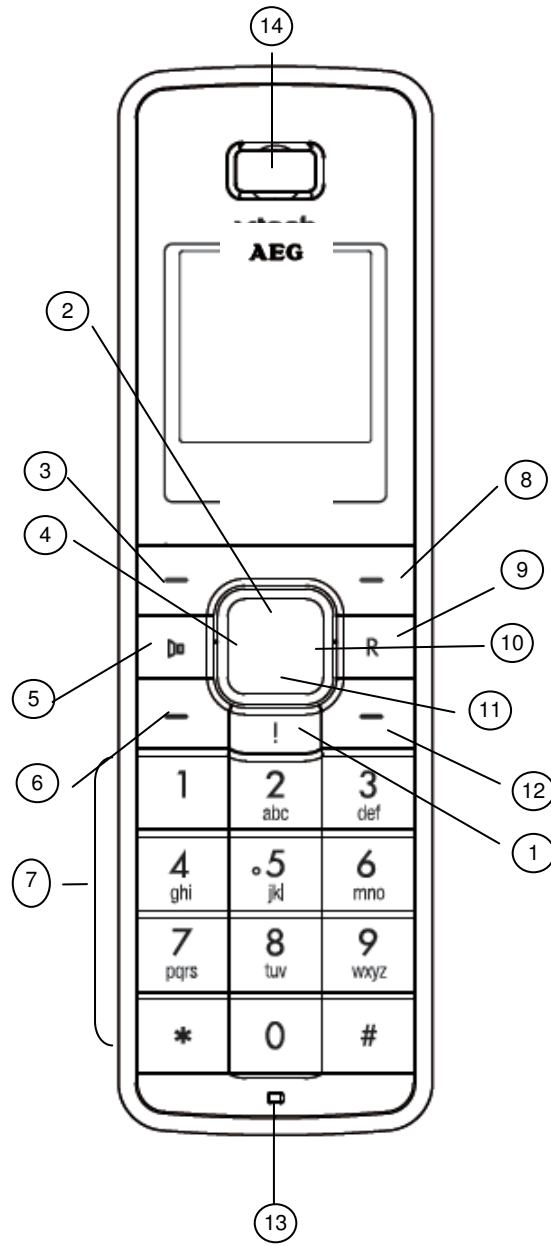

1	INFO Press to access ten important phone numbers that share with all handsets	8	RIGHT SOFT KEY In idle mode: Press to access the main menu In sub-menu mode: Press to confirm the selection During call screening: Press to activate call screening on handset During answering machine message playback: Press to play or pause the message playback
2	UP/REDIAL In idle mode: Press to access the redial list In menu mode: Press to scroll up the menu items In Phonebook list / Redial list / Call List: Press to scroll up the list During a call: Press to increase the volume In editing mode: Press to go one line upwards	9	RECALL / FLASH In idle / predialing mode: Press to insert a flash During a call: Press to dial a flash
3	LEFT SOFT KEY In idle mode: Press to select a handset to make an internal call In sub-menu mode: Press to go back to previous level In contextual menu during a call: Press to go back previous level In editing / predialing mode: Press to clear a character / digit In editing / predialing mode: Long press to delete all the characters / digit During answering machine message playback: Press to delete the current message	10	RIGHT In Idle : Press to access the status summary of call list, SMS and answering machine messages. In sub-menu mode: Press to go to next menu level In Call list: Press to view the details of the selected call list entry In predialling / editing mode: Press to move the cursor one character to the right During answering machine message playback: Press to skip forward to next message
4	LEFT/ PHONEBOOK In idle mode: Press to access phonebook In main menu mode: Press to go back to idle In sub-menu mode: Press to go back to previous level During a call: Press to mute / unmute the microphone In predialling mode: Press to move the cursor one character to the left During answering machine message playback: Press to skip backward to previous message	11	DOWN / CALL LIST In idle mode: Press to access the call list In menu mode: Press to scroll down the menu items In Phonebook list / Redial list / Call List: Press to scroll down the list During a call: Press to decrease the volume In editing mode: Press to go one line downwards
5	SPEAKERPHONE During a call: Press to turn on / off the speakerphone. Call List / Phonebook entry: Press to make a call with speakerphone During ringing: Press to answer a call with speakerphone During answering machine message playback/call screening: Press to play the message via speaker	12	TALK OFF During a call: Press to end a call and go back to idle screen In menu / editing mode: Press to go back to idle screen In Idle : Press and hold to choose to power off the handset When the handset is power off: Press to power on the handset
6	TALK ON In idle / predialing mode : Press to make a call In Redial list / Call List/ Phonebook entry: Press to make a call to the selected entry in the list During ringing: Press to answer a call During call screening: Press to intercept a call	13	MICROPHONE
7	ALPHANUMERIC KEYPAD, * (STAR), # (HASH) Press to insert a digit / character / * / # * key in idle mode: Long press to turn off the ringer # key in editing mode: Press to toggle between uppercase or lowercase character input # key in Idle mode: Long press to turn on / off the keypad lock 0 key in idle / predialing / number editing mode: Long press to insert a pause In Idle : Press and hold key 1 to access the network voice mail (if applicable) In Idle : Press and hold any digit key (except 1, *, #) to access the number stored in the respective digit key (applicable if user has stored numbers in the speed dial locations)	14	EARPIECE

3.2 Base Overview

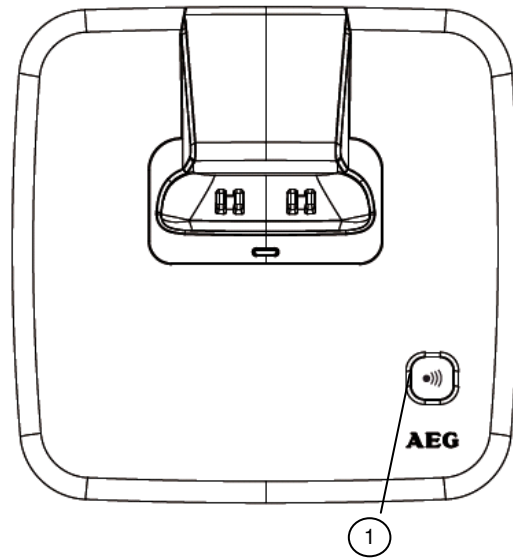

PAGE

Press to ring all registered handsets. You can make use of this to find the missing handset..
Long press to enter into registration mode.

3.3 Handset LCD Display



Sample idle screen display

Icons	Description
	Steady when the handset is in range of the base. Flash when the handset is in marginal range of the base. Off when the handset is not registered to the base or out of range
	Indicate when new SMS is received. Flash when the SMS inbox is full. Turn off when all new SMS have been read.
	Indicate when missed call is received (Network Subscription is required). Turn off when at least one missed call has been read.
	Indicate when new answering machine message is received. Flash when the answering machine memory is full. Turn off when no new answering machine message.
	Indicate a call is in progress. Flash when ringing.
	Indicate that handsfree is being used.
	Indicate the answering machine is turned on. Turn off if the answering machine is turned off.
	Indicate that the alarm is set. Flash when the alarm time is reached. Turn off when the alarm is off.
	Indicate that the ringer is switched off.
	Indicate that the keypad is locked.
	Indicate when ECO mode is enabled.
	Indicate when the battery is fully charged.
	Indicate when the battery is 1/4 charged.
	Indicate when the battery is 1/2 charged.
	Indicate when the battery is 3/4 charged.
	Flash when low battery is detected and indicate that it needs charging.
	Animate during charging

3.4 Menu Structure

In idle mode, press <MENU> will firstly access the SMS menu. Press <DOWN> will access the Call List. Refer to the following for the menu structure. Press <UP> will access the Redial List.

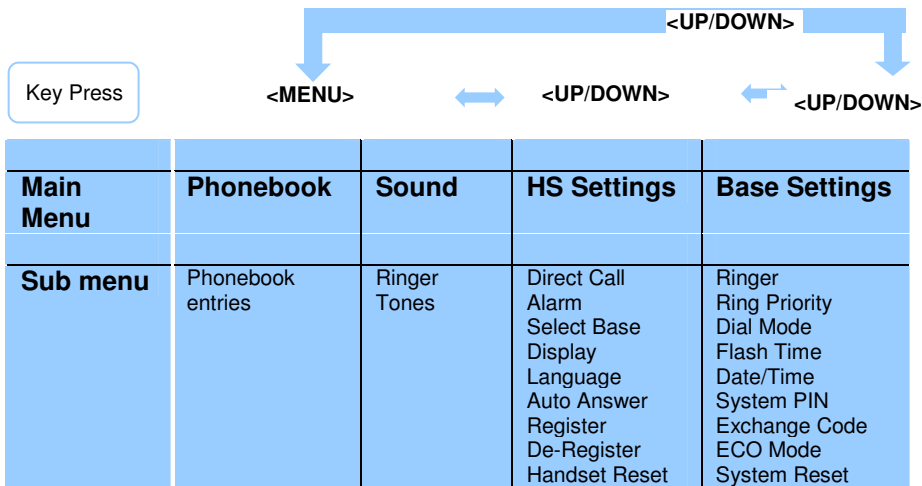

The following menus can be accessed by pressing relevant keys in idle mode:

Keys	UP/REDIAL	Down / Call List	Left / Phonebook or	Left / Phonebook
	List Empty or Display Redial List	List Empty or Display Call List	List Empty	Display Phonebook entries
Sub menu	Delete Delete All Call Number Store Number	Details Delete Delete All Call Number Store Number Settings	New Entry Capacity	New Entry Edit Entry View Copy Copy All Delete Entry Delete All Capacity Edit Call Gp Speed Dial

4 USE YOUR PHONE

4.1 Make an External Call

4.1.1 Preparatory dialing

Enter the phone number and press <TALK ON> or <SPEAKERPHONE> to dial the number. Press <Clear> to clear the entry.

4.1.2 Direct dialing

Press <TALK ON> or <SPEAKERPHONE> to take the line and enter the phone number.

4.1.3 Call from the phonebook

Press <LEFT> to access the phonebook and press <UP/DOWN> to select the desired phonebook entry. Press <TALK ON> or <SPEAKERPHONE> to dial out to the selected phonebook entry.

4.1.4 Call from the call list

Press <DOWN> to access the call list and press <UP/DOWN> to select the desired call list entry. Press <TALK ON> or <SPEAKERPHONE> to dial out to the selected call list entry.

4.1.5 Call from the redial list

Press <UP> to access the redial list and press <UP/DOWN> to select the desired redial number. Press <TALK ON> or <SPEAKERPHONE> to dial out to the selected redial number.

4.1.6 Call timer

Your handset automatically times the duration of every call. The call timer will display a few seconds after the call has made. It is shown in hours, minutes and seconds format (HH:MM:SS).

4.2 Answer a Call

If handset is not on the charging cradle:

When the phone rings, press <TALK ON> / <SPEAKERPHONE> to answer a call.

If the handset is on the charging cradle or the base station:

When the phone rings, pick up the handset to answer a call.

4.3 End a Call

During a call connection, press <TALK OFF> to end the call.

OR

Put the handset on the base station to end the call.

4.4 Adjust Earpiece and Handsfree Volume

5 volume levels (Level 1 to Level 5) to choose from for each of earpiece and handsfree volume.

During a call:

Press <UP> or <DOWN> to increase or decrease the volume level respectively. The current setting is shown.

When you end the call, the settings will remain at the last selected level.

4.5 Mute a Call

You can talk to someone nearby without letting the caller hear you during a call.

During a call:

Press <LEFT> to mute the microphone and "**Mute On**" is displayed on the LCD. Your caller cannot hear you.

Press <LEFT> again to unmute the microphone.

4.6 Set the Silent Mode

In idle, press and hold <STAR> to turn off the ringer. The “RINGER OFF” icon is displayed on the LCD.

4.7 Redial

You can redial up to 15 of the last numbers called. If you have stored a name in the phonebook to go with the number, the name will be displayed instead.

Note: After making a call, further key input after call timer is displayed will not be stored in the redial list.

4.7.1 Redial a number from the redial list

1. Press <UP> to access the redial list.
2. Press <UP/DOWN> to browse the redial list.
3. Press <TALK ON> to dial to the selected redial number.

Note: If there are no numbers in the redial list, the display shows “*List Empty*”.

4.7.2 Save a redial number into the phonebook

1. Follow steps 1 and 2 in section 4.7.1.
2. Press <Option> and <UP/DOWN> to select **Store Number**.
3. Press <OK> to enter the name, edit the number and select the group if necessary.
4. Press <OK> to save the redial number into the phonebook.

4.7.3 Delete a redial number

1. Follow steps 1 and 2 in section 4.7.1.
2. Press <Option> and <UP/DOWN> to select **Delete**.
3. Press <OK> to confirm.

4.7.4 Delete the entire redial list

1. Follow steps 1 and 2 in section 4.7.1.
2. Press <Option> and <UP/DOWN> to select **Delete list**.
3. Press <OK> to confirm.

4.8 Keypad Lock

You can lock the keypad so that it cannot be used accidentally while carrying it around.

1. To lock the keypad: In idle mode, press and hold <#> key, the <Keypad lock icon> will display and “**Keypad Locked**” will display.
2. To unlock the keypad: In idle mode, press and hold <#> key, the <keypad lock icon> will disappear and “**Keypad Unlocked**” will display for 2 seconds before returning to standby.

4.9 Find Handset

You can locate the handset by pressing <PAGE> on the base station. All the handsets registered to the base will ring up for 30 seconds and “**Paging**” is displayed on the LCD. You can stop the paging by pressing <TALK OFF> or <Back> on the handset or <PAGE> on the base again.

4.10 Access Inbox

You can press <RIGHT> to review the summary of missed calls, SMS and answering machine messages. New event is indicated by “New”.

In Idle:

1. Press <RIGHT> to access the **Inbox**.
2. Press <UP/DOWN> to select **Calls, Msg or SMS**.
3. Press <OK> to view the Call List, play answering machine message or SMS Inbox.
4. Press <Back> or <TALK Off> to return to Idle.

4.11 Make an Internal Call

This feature is only applicable when there are at least two registered handsets. It allows you to make internal calls, transfer external calls from one handset to another handset and make conference calls.

4.11.1 Intercom another handset

1. Press <Int> and <RIGHT/LEFT> to select the handset that you want to make an internal call with.
2. Press <OK>.
3. The called handset rings and press <TALK ON> on the called handset to establish the internal call.

4.11.2 Transfer an external call to another handset

During a call:

1. Follow steps 1 and 2 in section 4.11.1.
2. The external call is put on hold automatically and the called handset rings.
3. Press <TALK ON> on the called handset to establish an internal call.
4. Press <TALK OFF> on the calling handset to end the current call with the external party.
5. The external call is transferred to the called handset.

4.11.3 Make a 3-way conference call

The conference call feature allows one external call to be shared with two handsets (in intercom). The three parties can share the conversation and no network subscription is required.

During an external call:

1. Follow Steps 1 to 3 in section 4.11.2.
2. Press <Conf> to establish the 3-way conference.

Any handset hangs up during a conference call will leave the other handset still in connection with the external call.

During the conference call:

1. Press <Single> on the calling handset to select **Single call**.
2. The calling handset talks to the internal party and the external party is put on hold automatically.

During an external call:

1. Follow steps 1 to 3 in section 4.11.2
2. Press <Switch> on the calling handset to switch calls.
3. The calling handset talks to the called handset and the external call is put on hold automatically.
4. Press <Switch> again on the calling handset to switch calls.
5. The calling handset is switched to talk to the external party and the internal call is put on hold automatically.

5 PHONEBOOK

Your phone can store up to 200 private phonebook entries with names and numbers. Each phonebook entry can have a maximum of 24 digits for the phone number and 15 characters for the name. You can categorize your phonebook entry into one of the seven call groups.

5.1 Add a New Entry

In idle:

1. Press <LEFT> to access the phonebook.

OR

1. Press <MENU> and <4-Way Key> to select **Phonebook** to access the phonebook menu.

Note: If no entry is found in the phonebook, "**List Empty**" will display.

2. Press <UP/DOWN> to select the desired phonebook entry.

3. Press <Option> and <UP/DOWN> to select **New Entry**.

4. Press <OK> and <UP/DOWN> to enter the name, number and call group.

Note: You can press <#> to toggle between the uppercase and lowercase letters. Phone number is mandatory to enter in order to save it as a phonebook entry.

5. Press <OK> to save the phonebook entry.

Note: Once a new entry is added, the phonebook entry will be displayed in alphabetical order.

5.2 Edit an Entry

In idle:

1. Press <LEFT> to access the phonebook.

OR

1. Press <MENU> and <4-Way Key> to select **Phonebook** to access the phonebook menu.

2. Press <UP/DOWN> to select the desired phonebook entry.

3. Press <Option> and <UP/DOWN> to select **Edit Entry**.

4. Enter the revised name, phone number and call group and press <OK>.

5. Press <OK> to confirm.

5.3 View an Entry

In idle:

1. Press <LEFT> to access the phonebook.

OR

1. Press <MENU> and <4-Way Key> to select **Phonebook** to access the phonebook menu.

2. Enter the first character of the name by multi-tap.

OR

2. Press <UP/DOWN> to select the desired phonebook entry.

3. Press <Option> and <UP/DOWN> to select **View**.

4. Press <OK> to confirm.

5.4 Copy an Entry

In idle:

1. Press <LEFT> to access the phonebook and press <UP/DOWN> to select the desired entry.

OR

1. Press <MENU> and <4-Way Key> to select **Phonebook** to access the phonebook menu. Press <UP/DOWN> to select the desired entry.

2. Press <Option> and <UP/DOWN> to select **Copy**.

3. Press <OK> and <LEFT/RIGHT> to select the handset you want to copy.

Note: If no base or other handsets are registered, "**Not Available**" will display on the screen.

At the receiving handset:

4. Display shows "**Receive PB entries?**" Press <Yes> to confirm or <No> to cancel.

5. Upon successful copying, the display will show "**Copied**".

Note: The PB entries in the initiating handset are copied and appended to existing PB entries in the receiving handset and are sorted in alphabetical order.

5.5 Copy all Entries

In idle:

1. Press <LEFT> to access the phonebook. The first entry is displayed.

OR

1. Press <MENU> and <4-Way Key> to select **Phonebook** to access the phonebook menu. The first entry is displayed.

2. Press <Option> and <UP/DOWN> to select **Copy All**.

3. Press <OK> and <LEFT/RIGHT> to select the handset you want to copy.

Note: if no base or other handsets are registered, "**Not Available**" will display on the screen.

At the receiving handset:

4. Display shows *Receive PB entries?* Press <Yes> to confirm or <No> to cancel.

5. Upon successful copying, the display will show "**Copied**".

Note: The PB entries in the initiating handset are copied and appended to existing PB entries in the receiving handset and are sorted in alphabetical order.

5.6 Delete an Entry

In idle:

1. Press <LEFT> to access the phonebook.

OR

1. Press <MENU> and <4-Way Key> to select **Phonebook** to access the phonebook menu.

2. Press <UP/DOWN> to select the desired phonebook entry.

3. Press <Option> and <UP/DOWN> to select **Delete**.

4. Press <Yes> to confirm or <No> to cancel.

5.7 Delete the Entire Phonebook

In idle:

1. Press <LEFT> to access the phonebook.

OR

1. Press <MENU> and <4-Way Key> to select **Phonebook** to access the phonebook menu.

2. Press <UP/DOWN> to select the desired phonebook entry.

3. Press <Option> and <UP/DOWN> to select **Delete All**.

4. Press <Yes> to confirm or <No> to cancel.

5.8 View Phonebook Capacity

In idle:

1. Press <LEFT> to access the phonebook.

OR

1. Press <MENU> and <4-Way Key> to select **Phonebook** to access the phonebook menu.

2. Press <Option> and <UP/DOWN> to select **Capacity**.

3. Press <OK> to display the number of entries remaining in the phonebook memory.

5.9 Edit Call Group

5.9.1 Edit call group name

In idle:

1. Press <LEFT> to access the phonebook.

OR

1. Press <MENU> and <4-Way Key> to select **Phonebook** to access the phonebook menu.

2. Press <Option> and <UP/DOWN> to select **Edit Call Gp**.

3. Press <OK> and <UP/DOWN> to the desired call group

4. Press <OK> to select **Rename Group**.

5. Press <OK> and <Clear> to delete the current name and enter a new name.

6. Press <OK> to save.

5.9.2 Change call group ringtone

In idle:

1. Press <LEFT> to access the phonebook.

OR

1. Press <MENU> and <4-Way Key> to select **Phonebook** to access the phonebook menu.

2. Press <Option> and <UP/DOWN> to select **Edit Call Gp**.

3. Press <OK> and <UP/DOWN> to the desired call group.

4. Press <OK> to select **Set Ringtone**.

4. Press <OK> and <LEFT/RIGHT> or to choose the desired melody. Corresponding melody is played while browsing the melody list. A total of 10 melodies are provided for your selection.

5. Press **OK** to confirm.

5.10 Speed Dial

5.10.1 Edit a speed dial

In idle:

1. Press <LEFT> to access the phonebook.

OR

1. Press <MENU> and <4-Way Key> to select **Phonebook** to access the phonebook menu.

2. Press <Option> and <UP/DOWN> to select **Speed Dial**.

3. Press <OK> and <UP/DOWN> to select **the speed dial location**.

4. Press <OK> to display the details of the speed dial location.

Note: If no number is stored in the selected speed dial location, "**No Number**" will display in the screen.

5. Press <Option> and <UP/DOWN> to select **Edit**.

6. Press <OK> to display the phonebook entries.

7. Press <UP/DOWN> to select your desired phonebook entry that you want to store in the selected speed dial location.

8. Press <OK> to confirm.

5.10.2 Delete a speed dial

In idle:

1. Repeat steps 1 to 4 in Section 5.10.1

2. Press <Option> and <UP/DOWN> to select **Delete**.

3. Press <OK> to confirm.

6 CALL LIST

This feature is available if you have subscribed the Caller Line Identification service with your network service provider. Your phone can store up to 30 calls (EEPROM option to choose storing all calls or unanswered calls only) with date/time information in the call list. The number will be shown on the LCD when the phone is ringing. If the number matches with one of the entries in your private phonebook, the caller's name stored in the private phonebook will be displayed alternatively with the number.

If the caller number is withheld, "**Withheld**" will display.

If the caller number is unavailable, "**Unavailable**" will display.

6.1 View the Call List

All unanswered calls are saved in calls log with the latest call putting at the top of the list. When the call list is full, the oldest call will be replaced by a new call. The unanswered call which has not been read is marked with "**New**" at the bottom of the unanswered call entry.

1. Press <DOWN> to access the call list.
2. Press <UP/DOWN> to select the desired entry.
3. Press <Option> and <UP/DOWN> to select **Details**.
4. Press <OK> to view the date and time information of the selected call list entry.

6.2 Store a Call List Number into the Phonebook

1. Follow steps 1 and 2 in Section 6.1.
2. Press <Option> and <UP/DOWN> to select **Store Number**.
3. Press <OK> and <UP/DOWN> to enter the name, number and call group if necessary.
4. Press <OK> to confirm.

6.3 Dial a Call List Number

1. Follow steps 1 and 2 in Section 6.1.
2. Press <Option> and <UP/DOWN> to select **Call Number**.
3. Press <OK> and you can edit the selected call list number.
4. Press <TALK ON> to dial out to the call list number.

6.4 Delete an Entry in the Call List

1. Follow steps 1 and 2 in Section 6.1.
2. Press <Option> and <UP/DOWN> to select **Delete**.
3. Press <OK> to confirm.

6.5 Delete the Entire Call List

1. Follow steps 1 and 2 in Section 6.1.
2. Press <Option> and <UP/DOWN> to select **Delete All**.
3. Press <OK> to confirm.
4. Press <OK> to reconfirm.

6.6 Store All Calls or Only Unanswered Calls in the Call List

If **All Calls** is selected, answered and unanswered calls are stored in the call list. If **Missed Calls** is selected, only unanswered calls are stored in the call list.

1. Follow steps 1 and 2 in Section 6.1.
2. Press <Option> and <UP/DOWN> to select **Settings**.
3. Press <OK> and <LEFT/RIGHT> to choose **All Calls** or **Missed Calls**.
4. Press <OK> to confirm.

6.7 Turn On or Off the New Call Alert

If New Call Alert is turned on, you will hear a beep when there is a missed call and <Missed Call icon> will display .

1. Follow steps 1 and 2 in Section 6.1.
2. Press <Option> and <UP/DOWN> to select **Settings**.
3. Press <OK> and <UP/DOWN> to go to **New Call Alert**.
4. Press <LEFT/RIGHT> to turn on or off the new call alert.
5. Press <OK> to confirm.

7 SOUND

You can set different melodies to personalize your external and internal ringer. A total of **10** melodies are provided for your selection.

7.1 Handset Ringer

In Idle:

1. Press <Menu> and <4-Way Key> to select **Sound**.
2. Press <OK> and <UP/DOWN> to select **Ringer**.
3. Press <OK> and <LEFT/RIGHT> to select your desired melody for your external ringer.
4. Press <DOWN> and <LEFT/RIGHT> to select your desired melody for your internal ringer.
5. Press <DOWN> and <LEFT/RIGHT> to select your desired ringer volume from **Level 1** to **Level 5** or **Off**.

Note: If the ringer volume is set to **Off**, <Ringer off icon> will display in idle.

6. Press <DOWN> and <LEFT/RIGHT> to set **Silent** to **Beep**.

Note: When you set the ringer to Off, you can still hear a beep when there is an incoming call by setting the Silent to Beep. If you set the Silent to Off, you cannot hear any tone when there is an incoming and the ringer is set to Off.

7. Press <OK> to confirm.

7.2 Tones

Your handset can give a beep to you when an action is confirmed to be successful, out of range is detected, a key is pressed or low battery is detected.

In Idle:

1. Press <Menu> and <4-Way Key> to select **Sound**.
2. Press <OK> and <UP/DOWN> to select **Tones**.
3. Press <OK> and <LEFT/RIGHT> to turn on or off the **Key Beeps**.
4. Press <DOWN> and <LEFT/RIGHT> to turn on or off the **Confirmation** tone.
5. Press <DOWN> and <LEFT/RIGHT> to turn on or off the **Battery Low** alert tone.
6. Press <DOWN> and <LEFT/RIGHT> to turn on or off the **Out of Range** alert tone.
7. Press <OK> to confirm.

8 SETTINGS

Your phone comes with a selection of settings that you can change to personalize your phone the way you like it to work.

8.1 Handset Settings

8.1.1 Enable the Direct Call

When activated, the direct call feature enables you to dial the selected number by pressing any key on your handset. This feature is very useful for direct access to emergency service.

1. Press <MENU> and <4-way Key> to select **HS Settings**.
2. Press <OK> and <UP/DOWN> to select **Direct Call**.
3. Press <OK> to enter the 4-digit system PIN. (Default 4-digit system PIN is 0000)
4. Press <OK> and <LEFT/RIGHT> to select **On** to enable the direct call.
5. Press <OK> to enter the number for direct call.
6. Press <OK> to return to Idle displaying with **"Direct Call"**.

8.1.2 Disable the Direct Call

1. Repeat steps 1 to 3 mentioned in section 8.1.1.
2. Press <OK> and <LEFT/RIGHT> to select **Off** to disable the direct call.
3. Press <OK> and return to previous menu level.

OR

1. Repeat steps 1 to 6 mentioned in section 8.1.1.
2. Press <Option> and <LEFT/RIGHT> to select **Off** to disable the direct call.
3. Press <OK> to confirm.

8.1.3 Set an alarm

In Idle:

1. Press <Menu> and <4-Way Key> to select **HS Settings**.
2. Press <OK> and <UP/DOWN> to select **Alarm**.
3. Press <OK> to enter the alarm time using the 24 hour format.
4. Press <DOWN> and <LEFT/RIGHT> to turn on or off the alarm.
5. Press <DOWN> and <LEFT/RIGHT> to select the alarm melody.
6. Press <OK> to confirm.

8.1.4 Set an alarm

In Idle:

1. Press <Menu> and <4-Way Key> to select **HS Settings**.
2. Press <OK> and <UP/DOWN> to select **Alarm**.
3. Press <OK> to enter the alarm time using the 24 hour format.
4. Press <DOWN> and <LEFT/RIGHT> to turn on or off the alarm.
5. Press <DOWN> and <LEFT/RIGHT> to select the alarm melody.
6. Press <OK> to confirm.

8.1.5 Select base station

If your handset is registered to more than one base stations, you can select which base station to use.

1. Press <MENU> and <UP/DOWN> to select **HS Settings**.
2. Press <OK> and <UP/DOWN> to choose **Select Base**.
4. Press <OK> and <LEFT/RIGHT> to select your desired base station.
5. Press <OK> to confirm.

8.1.6 Adjust the display contrast, rename handset, select wallpaper and colour theme

1. Repeat step 1 in section 8.1.1.
2. Press <OK> and <UP/DOWN> to choose **Display**.
3. Press <OK> and <LEFT/RIGHT> to select the contrast level from 1 to 8.
4. Press <DOWN> to rename the handset.
5. Press <Clear> to delete one character.
6. Press <DOWN> to go to wallpaper selection.
7. Press <RIGHT/LEFT> to select your desired wallpaper.
8. Press <DOWN> to select colour theme.

9. Press <RIGHT/LEFT> to select your desired colour theme.
10. Press <OK> to confirm.

8.1.7 Set language (Optional)

1. Repeat step 1 in section 8.1.1.
2. Press <OK> and <UP/DOWN> to select **Language**.
3. Press <OK> and <LEFT/RIGHT> to select the desired language.
4. Press <OK> to confirm.

8.1.8 Turn on or off the auto answer

1. Repeat step 1 in section 8.1.1.
2. Press <OK> and <UP/DOWN> to select **Auto Answer**.
3. Press <OK> and <LEFT/RIGHT> to turn on or off the Auto Answer feature.
4. Press <OK> to confirm.

8.1.9 Register an additional handset

You can register up to 5 handsets per base station.

1. Repeat step 1 in section 8.1.1.
2. Press <OK> and <UP/DOWN> to select **Register**.
3. Press <OK> and <LEFT/RIGHT> to select the desired base station that you want your handset to register to.
4. Press <OK> to enter the 4-digit system PIN.

Note: 4-digit PIN is entered in ****. Once 4 digits are entered, the right soft key will become OK.

5. Press and hold <PAGE> on the base station.

6. Press <OK> on the handset to confirm.

Note: “**Registering...**” will display. A beep tone is emitted from the handset to indicate successful registration and the screen returns to idle mode.

If the base is found and the PIN is correct, an unused handset number will be assigned automatically.

If the PIN is incorrect, “**Incorrect PIN**” will display with an error tone, and the handset returns to idle.

If no base is found within a certain period, “**No Base Found**” will display with an error tone, and the handset returns to idle..

8.1.10 De-Register a handset

1. Repeat step 1 in section 8.1.1.
 2. Press <OK> and <UP/DOWN> to select **De-register**.
 3. Press <OK> to enter the 4-digit System PIN.
- Note: 4-digit PIN is entered in ****. Once 4 digits are entered, the right soft key will become OK.
4. Press <OK> and <LEFT/RIGHT> to select the handset that you want to de-register.
- Note: Only subscribed handsets are listed. The handset currently used cannot be de-registered.
5. Press <OK> to de-register the handset.
 6. Press <YES> to confirm handset de-registration.
 7. “**De-registered**” will display and go back to idle.

8.1.11 Restore the handset to default settings

1. Repeat step 1 in section 8.1.1.
 2. Press <OK> and <UP/DOWN> to select Handset Reset.
 3. Press <OK> and <YES> to confirm resetting the handset to default settings.
- Note: Phonebook and speed dial entries will not be deleted after handset reset.

8.2 Base Settings

8.2.1 Set the base ringer

In Idle:

1. Press <Menu> and <4-Way Key> to select **Base Settings**.
- 2 Press <OK> and <UP/DOWN> to select **Ringer**.
- 3 Press <OK> and <LEFT/RIGHT> to select your desired melody for your base ringer. (A total of five melodies for base ringer are provided.)
4. Press <DOWN> and <LEFT/RIGHT> to select your desired ringer volume from **Level 1 to Level 5 or Off**.
5. Press <OK> to confirm.

8.2.2 Set the handset priority

When you have more than one handset registered to the base station, you can set which handset to ring first before the others.

In Idle:

1. Repeat step 1 in section 8.2.1.
2. Press <OK> and <UP/DOWN> to select **Handset Priority**.
3. Press <OK> and <UP/DOWN> to choose **Select Handset**.
4. Press <OK> and <LEFT/RIGHT> to select which handset to get the priority to ring first.

Note: If All Handsets is chosen, all the registered handsets will ring at the same time and press <OK> to confirm.

5. Press <OK> and <LEFT/RIGHT> to select the number of ring delay (2 Rings / 4 Rings / 6 Rings / 8 Rings).
6. Press <OK> to confirm.

8.2.3 Set the dial mode

In Idle:

1. Repeat step 1 in section 8.2.1.
2. Press <OK> and <UP/DOWN> to select **Dial Mode**.
3. Press <OK> and <LEFT/RIGHT> to select **Tone** or **Pulse**.
4. Press <OK> to confirm.

8.2.4 Set the flash time

In Idle:

1. Repeat step 1 in section 8.2.1.
2. Press <OK> and <UP/DOWN> to select **Flash Time**.
3. Press <OK> and <UP/DOWN> to select the desired flash time.

Note:

Flash time options are country dependent.

4. Press <OK> to confirm.

8.2.5 Set date and time

In Idle:

1. Press <Menu> and <4-way key> to select **Base Settings**.
2. Press <OK> and <UP/DOWN> to select **Date/Time**.
3. Press <OK> and <LEFT/RIGHT> to select 12 hour or 24 hour format.
4. Press <DOWN> and <LEFT/RIGHT> to select dd/mm or mm/dd date format.
5. Press <DOWN> to enter the time. During time input, press <#> to toggle between AM or PM if 12 hour time format is selected.
6. Press <DOWN> to enter the date.
7. Press <OK> to confirm.

8.2.6 Change the system PIN

In Idle:

1. Repeat step 1 in section 8.2.1.
 2. Press <OK> and <UP/DOWN> to select **System PIN**.
 3. Press <OK> to enter the old 4-digit **system PIN**.
 4. Press <OK> to enter the new 4-digit system PIN.
 5. Press <OK> to enter the new 4-digit system PIN.
 6. Press <OK> to reconfirm and save the new 4-digit PIN.
- Note: If the PIN is incorrect, "**INCORRECT PIN**" will display with an error tone in the screen.

8.2.7 Set an exchange code

You can set an exchange code for your handset such that a pause will be inserted after the first digit if it matches with the exchange code. This feature is especially useful for PBX systems.

In Idle:

1. Repeat step 1 in section 8.2.1.
2. Press <OK> and <UP/DOWN> to select **Exchange Code**.
3. Press <OK> to enter the exchange code.
4. Press <OK> to confirm.

Note:

Only one digit is allowed to enter for the exchange code.

8.2.8 Activate the ECO mode (Optional)

Your telephone is provided with a low-emission mode. ECO mode is activated, as soon as you place the handset in the base station, the transmission power between handset and base station is reduced to the minimum. This applies to base with single handset registration only. If more than one handset is registered to the base station, the ECO mode will not function.

In Idle:

1. Repeat step 1 in section 8.2.1.
2. Press <OK> and <UP/DOWN> to select **ECO Mode**.
3. Press <OK> to select **On** to activate ECO mode.
4. Press <OK> to confirm.

8.2.9 Reset the base settings to default settings

After system reset, the phone will return to its original settings.

In Idle:

1. Repeat step 1 in section 8.2.1.
2. Press <OK> and <UP/DOWN> to select **System Reset**.
3. Press <OK> to enter the 4-digit System PIN.
Note: 4-digit PIN is entered in ****. Once 4 digits are entered, the right soft key will become OK.
4. Press <OK> and <YES> to confirm resetting the base settings to default settings.
The base will restore to default settings and return to standby.

9 DEFAULT SETTINGS

Items	Default Values
Call List	
All Calls or Unanswered Calls Only	All Calls
New Call Alert	On
Sound	
External Ringer Melody	Melody 1
Internal Ringer Melody	Melody 2
Ringer Volume	Level 3
Silence	Off
Key Beep Tone	On
Confirmation Tone	On
Low Battery Tone	On
Out of Range Tone	On
Handset Settings	
Direct Call	Off
Contrast	Level 5
Handset Rename	Empty
Wallpaper	Wallpaper 1
Colour Theme	Theme 1
Language	Country Dependent
Auto Answer	On
Base Settings	
Ringer Melody	Melody 1
Ringer Volume	Level 2
Handset Priority	All Handsets
Dial Mode	Tone
Flash Time	Country Dependent

10 TROUBLESHOOTING

If you have difficulty with your phone, please try the suggestions listed below.

Problem	Cause	Solutions
No dialing tone when pressing <TALK ON> key	<ul style="list-style-type: none"> a. The connection cord of the base station is not plugged in. b. The adapter cord is not plugged in correctly in the base station. c. The line is busy, as another handset is used. d. Wrong connection cord (no Euro AS) 	<ul style="list-style-type: none"> a. Check the connections. Unplug and plug back in the mains. Check that the telephone line cord has been plugged into the base station and the phone socket. b. Check the base station plug and the 220V plug (remove and plug-in). c. Wait until the line is unoccupied. d. Use the original connection cord.
When connect to a PBX, no and/or wrong connection after dialing.	Dialing prefix is needed.	Insert the dialing prefix
"Searching" is displayed.	Base station out of range. Base station not connected to mains.	Reduce the range. Connect base station to mains.
The call does not work.	Service not activated or wrong operator or wrong setting	Check your Subscription with network or change the dial mode.
No display.	Empty battery	Recharge battery

Please contact the technical support of the network provider for further information.

This telephone is not equipped with a grounding function! Therefore some of the functions may be limited when used in PBX systems.

CONFORMITY

This unit conforms to the following rules and regulations:
1995/5/EC Radio frequency and telecommunication equipment and the mutual acceptance of conformity.
The CE mark proves the above.